

Standard AC Motors

Watertight, Dust-Resistant Motors

Overview,
Product
Series

Constant
Speed
Motors

Three-Phase
Induction
Motors

Single-Phase
Induction
Motors

Reversible
Motors

Electromagnetic
Brake Motors

Clutch &
Brake Motors

Low-Speed
Synchronous
Motors

Torque
Motors

**Watertight, Dust-Resistant
Motors**

**Watertight,
Dust-Resistant
Motors**

Right-Angle
Gearheads

Linear
Heads

Brake Pack

Accessories

Installation

Watertight, Dust-Resistant Motors

FPW Series

Induction Type

For details on this product please refer to our website.

www.orientalmotor.com/catalog



For detailed information about regulations and standards, please see the Oriental Motor website.



View Expanded Product Information, Specifications, CAD, Accessories & more online. Visit www.orientalmotor.com/catalog or use the QR code and select "FPW Series".

- Geared motors that conform to IEC Standard IP67.
- Suitable for use in locations where the equipment is splashed or needs to be washed with water periodically.
- Output powers of 25 W (1/30 HP), 40 W (1/19 HP), 60 W (1/12 HP) and 90 W (1/8 HP) are available.

Features

● Watertight and Dust-Resistant Performance IP67

The **FPW** Series motors are watertight, dust-resistant geared induction motors which conform to the IEC Standard IP67. They can be used where they are splashed with water.

- Not available for use under high pressure jets of water or immersion in water

IP67: IP codes indicating the grade of dust-resistance and waterproofing are specified under IEC 60529 and IEC 60034-5.

FPW Series recognized by UL conforms to IP67 (UL File No. E166348).

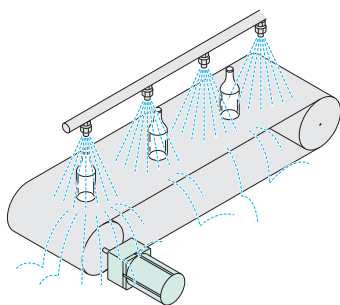

● Improved Anti-Corrosion Properties

High corrosion resistance is achieved through special anti-corrosive coating and shaft material of stainless steel (SUS303 type).

● Designed and Constructed for Watertight and Dust-Resistance

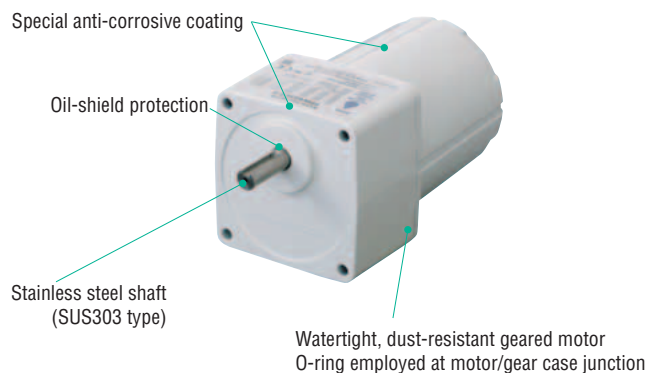

● Conforms to Standards

The **FPW** Series is recognized by UL/CSA Standards and conforms to CE Marking (Low Voltage Directive). These motors are also certified under the China Compulsory Certification System (CCC System).

System Configuration

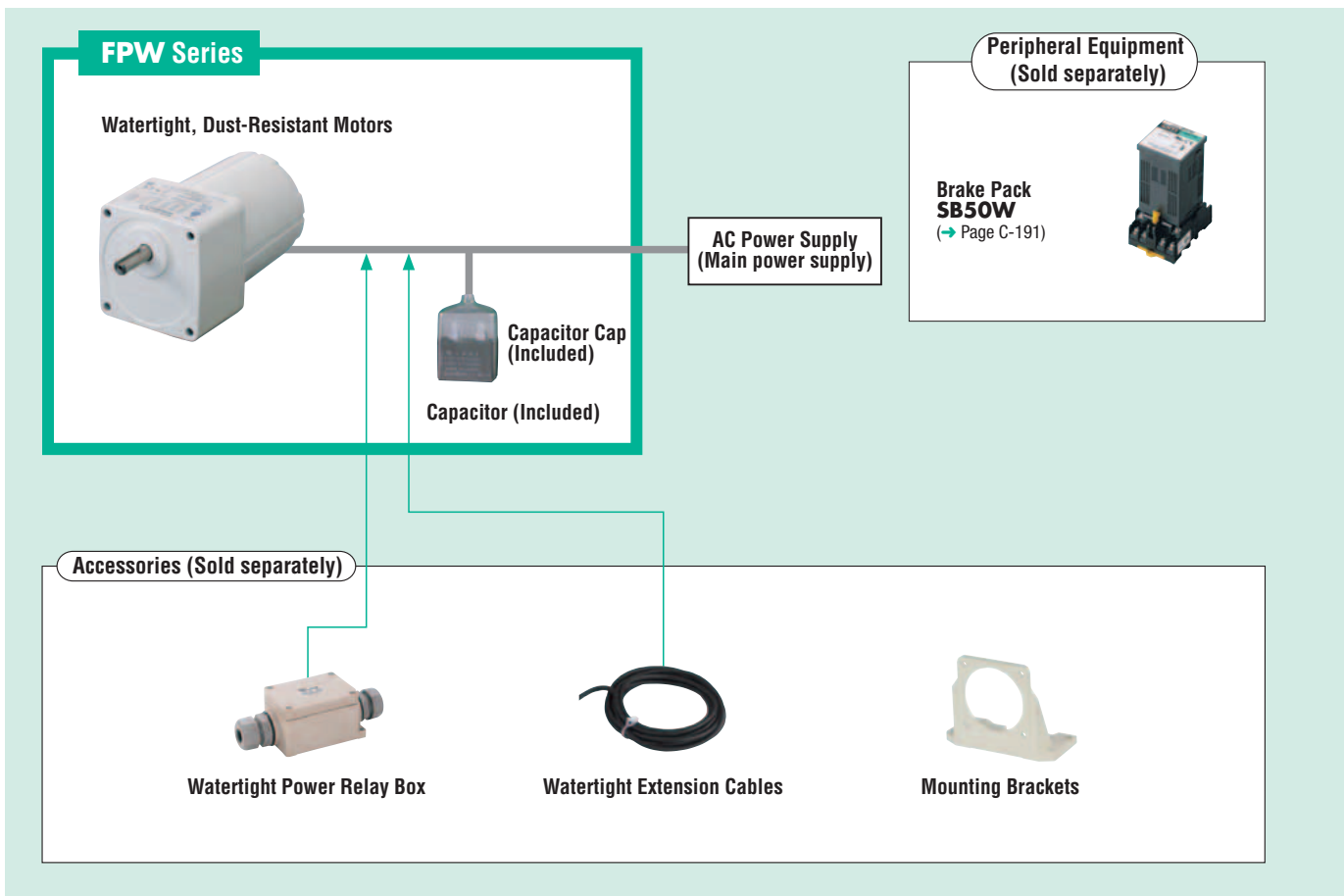

Overview, Product Series

Constant Speed Induction Motors

Three-Phase Induction Motors

Single-Phase Induction Motors

Reversible Motors

Electromagnetic Brake Motors

Clutch & Brake Motors

Low-Speed Synchronous Motors

Torque Motors

Watertight, Dust-Resistant Motors

Right-Angle Gearheads

Linear Heads

Brake Pack

Accessories

Installation

Product Number

FPW 4 25 A 2 - 15 U

① ② ③ ④ ⑤ ⑥ ⑦

| | | |
|---|----------------------|---|
| ① | Series | FPW: FPW Series |
| ② | Motor Frame Size | 4: 80 mm (3.15 in.) 5: 90 mm (3.54 in.) 6: 104 mm (4.09 in.) |
| ③ | Output Power (W) | (Example) 25: 25 W (1/30 HP) |
| ④ | Power Supply Voltage | S: Three-Phase 220/230 VAC A: Single-Phase 110/115 VAC C: Single-Phase 220/230 VAC |
| ⑤ | | 2: RoHS-Compliant |
| ⑥ | Gear Ratio | |
| ⑦ | Included Capacitor | U: For Single-Phase 110/115 VAC E: For Single-Phase 220/230 VAC Blank: Three-Phase Type |

● The **U** and **E** at the end of the product name indicate that the unit includes a capacitor. These letters are not listed on the motor nameplate.
When the motor is approved under various standards, the product name on the nameplate is the approved product name.
(Example) Model: **FPW425A2-15U**
→ Motor nameplate and product approved under various standards: **FPW425A2-15**

Product Line

| Output Power | Power Supply Voltage | Product Name | Gear Ratio | List Price |
|--------------------------|--------------------------|---|---|------------|
| 25 W (1/30 HP) | Three-Phase 220/230 VAC | FPW425S2-□ | 3, 3.6, 5, 6, 7.5, 9, 12.5, 15, 18 | \$295.00 |
| | | | 25, 30, 36 | \$306.00 |
| | | | 50, 60, 75, 90, 100, 120, 150, 180 | \$317.00 |
| | Single-Phase 110/115 VAC | FPW425A2-□U | 3, 3.6, 5, 6, 7.5, 9, 12.5, 15, 18 | \$291.00 |
| | | | 25, 30, 36 | \$302.00 |
| | | | 50, 60, 75, 90, 100, 120, 150, 180 | \$313.00 |
| Single-Phase 220/230 VAC | FPW425C2-□E | 3, 3.6, 5, 6, 7.5, 9, 12.5, 15, 18 | \$295.00 | |
| | | 25, 30, 36 | \$306.00 | |
| | | 50, 60, 75, 90, 100, 120, 150, 180 | \$317.00 | |
| 40 W (1/19 HP) | Three-Phase 220/230 VAC | FPW540S2-□ | 3, 3.6, 5, 6, 7.5, 9, 12.5, 15, 18 | \$359.00 |
| | | | 25, 30, 36 | \$370.00 |
| | | | 50, 60, 75, 90, 100, 120, 150, 180 | \$381.00 |
| | Single-Phase 110/115 VAC | FPW540A2-□U | 3, 3.6, 5, 6, 7.5, 9, 12.5, 15, 18 | \$355.00 |
| | | | 25, 30, 36 | \$365.00 |
| | | | 50, 60, 75, 90, 100, 120, 150, 180 | \$376.00 |
| Single-Phase 220/230 VAC | FPW540C2-□E | 3, 3.6, 5, 6, 7.5, 9, 12.5, 15, 18 | \$359.00 | |
| | | 25, 30, 36 | \$370.00 | |
| | | 50, 60, 75, 90, 100, 120, 150, 180 | \$381.00 | |
| 60 W (1/12 HP) | Three-Phase 220/230 VAC | FPW560S2-□ | 3, 3.6, 5, 6, 7.5, 9 | \$424.00 |
| | | | 12.5, 15, 18 | \$439.00 |
| | | | 25, 30, 36, 50, 60 | \$452.00 |
| | | | 75, 90, 100, 120, 150, 180 | \$465.00 |
| | Single-Phase 110/115 VAC | FPW560A2-□U | 3, 3.6, 5, 6, 7.5, 9 | \$419.00 |
| | | | 12.5, 15, 18 | \$432.00 |
| Single-Phase 220/230 VAC | FPW560C2-□E | 25, 30, 36, 50, 60 | \$447.00 | |
| | | 75, 90, 100, 120, 150, 180 | \$460.00 | |
| | | 3, 3.6, 5, 6, 7.5, 9 | \$424.00 | |
| | | 12.5, 15, 18 | \$439.00 | |
| 90 W (1/8 HP) | Three-Phase 220/230 VAC | FPW690S2-□ | 25, 30, 36, 50, 60 | \$452.00 |
| | | | 75, 90, 100, 120, 150, 180 | \$465.00 |
| | | | 3, 3.6, 5, 6, 7.5, 9 | \$522.00 |
| | Single-Phase 110/115 VAC | FPW690A2-□U | 12.5, 15, 18, 25, 30, 36 | \$536.00 |
| | | | 50, 60, 75, 90, 100, 120, 150, 180 | \$550.00 |
| | | | 3, 3.6, 5, 6, 7.5, 9 | \$516.00 |
| Single-Phase 220/230 VAC | FPW690C2-□E | 12.5, 15, 18, 25, 30, 36 | \$529.00 | |
| | | 50, 60, 75, 90, 100, 120, 150, 180 | \$543.00 | |
| | | 3, 3.6, 5, 6, 7.5, 9 | \$522.00 | |
| | | | 12.5, 15, 18, 25, 30, 36 | \$536.00 |
| | | | 50, 60, 75, 90, 100, 120, 150, 180 | \$550.00 |

● A number indicating the gear ratio is entered where the box □ is located within the product name.

The following items are included with each product.
 Motor, Capacitor*, Capacitor Cap*, Installation Screws, Parallel Key, Operating Manual
 * Only for single-phase motors

For details (specifications, characteristics, dimensions and others) on these products please refer to either to our website, contact technical support or your nearest Oriental Motor sales office.
www.orientalmotor.com/catalog